



## **DISCLAIMER**

This document or some parts of it may not be accessible when using adaptive technology.

If you require assistance with accessing the content of the document, please contact us and quote the document name and the web page you found it on:

- email: Forward planning – [localplan@ashfield.gov.uk](mailto:localplan@ashfield.gov.uk) .
- telephone: 01623 457381

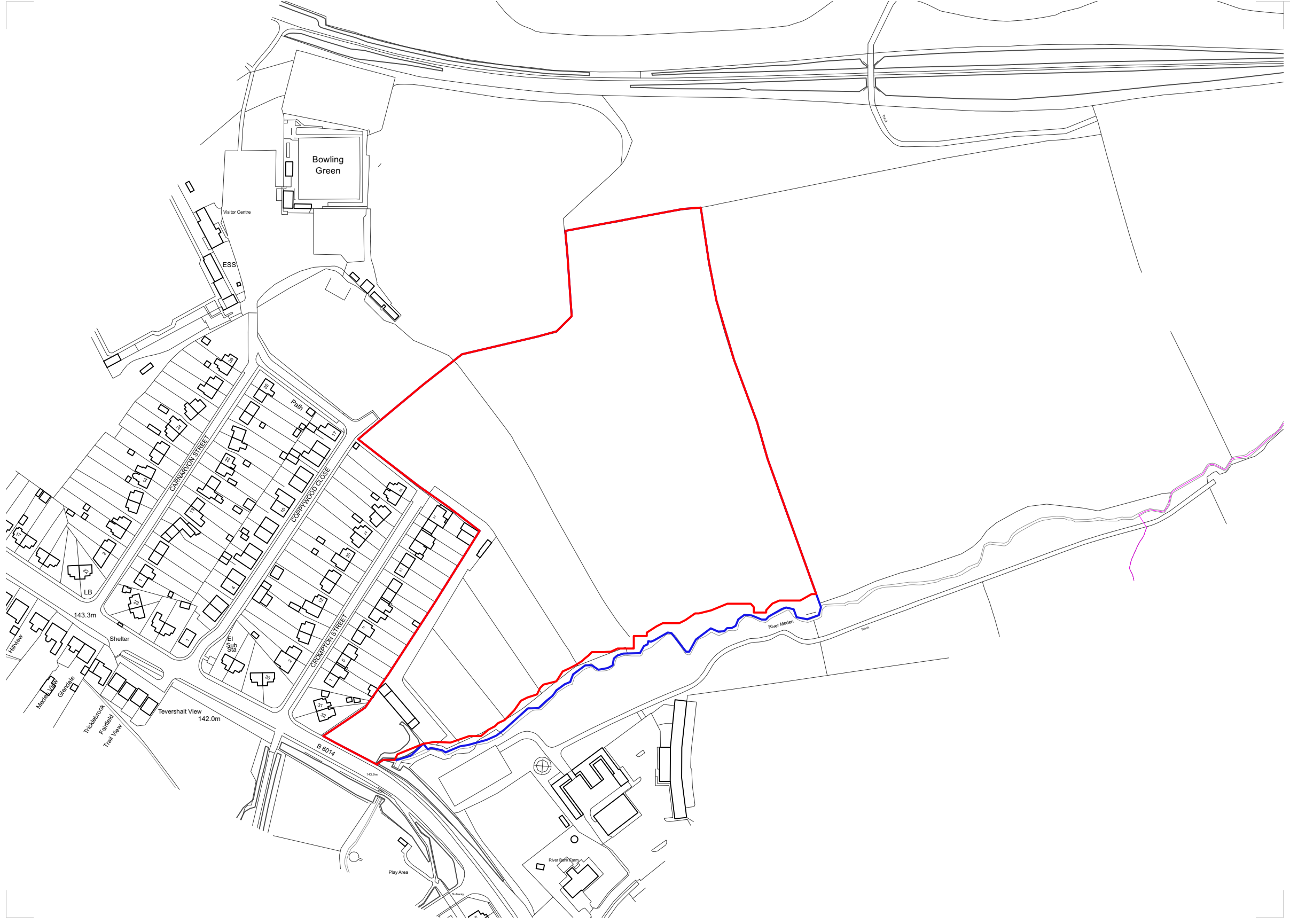

# FACKLEY ROAD, TEVERSAL – Site Location Plan

