



Hardwick View and Birds Walk

Grade 2 Walk from Brierley Forest Park Visitor Centre

Distance: 4.02 km / 2.5 miles

Following Footpath Numbers: 9, 12, 13, 11, 7, 6, 5

This is a slightly challenging medium length walk. It includes gentle inclines, descends and passes through a steel kissing gate.

As implied by the name, this walk provides walkers with stunning views across the countryside to Hardwick Hall in Derbyshire, the magnificent Elizabethan country home of Bess of Hardwick. The walk takes in the beautiful woodland, parkland and meadows of Brierley Forest Park and includes most of the sculpture trail, the play trail, and the array of wildlife around Brierley fishing pond as you meander your way through the park.

Like all of the walks there are plenty of seats along the route to take a well-earned rest whilst enjoying the stunning views, the local flora and fauna and the peace and tranquillity of Brierley Forest Park.

Hardwick View & Birds Walk

Grade 2
Distance 4km (2.5 miles)

A full risk assessment was carried out during the creation of this walking route, however risks are continually changeable. Walkers will be walking this route at their own risk. If any hazards are identified during your walk, please report them to Ashfield District Council on 0800 1838484

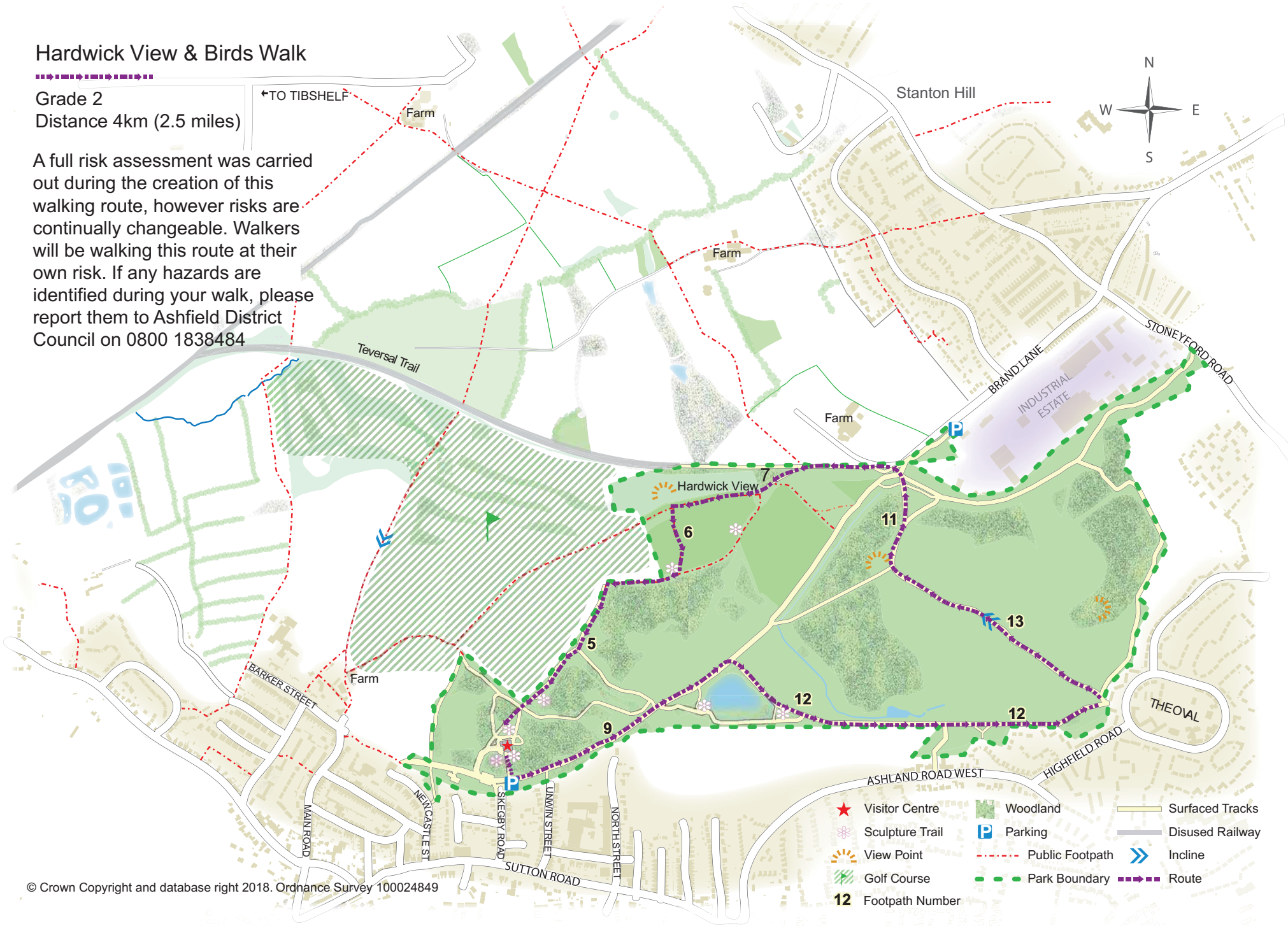

- Visitor Centre
- Sculpture Trail
- View Point
- Golf Course
- Footpath Number
- Woodland
- Parking
- Public Footpath
- Park Boundary
- Surfaced Tracks
- Disused Railway
- Incline
- Route

